

2600W

KINGFISHER
gardening
TM

Garden Blower Vac

Ideal for maintaining the perfect garden

- 2 Operating modes
- Includes debris collection bag
- Robust shoulder harness
- Lightweight and robust
- Wheel aided steering



PLEASE KEEP THESE INSTRUCTIONS FOR FUTURE REFERENCE

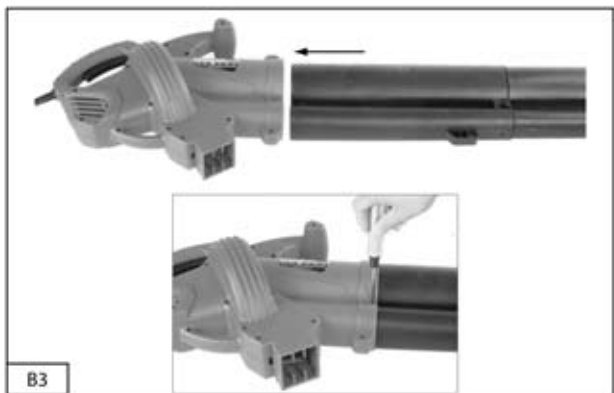
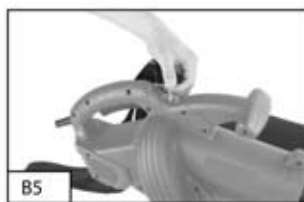
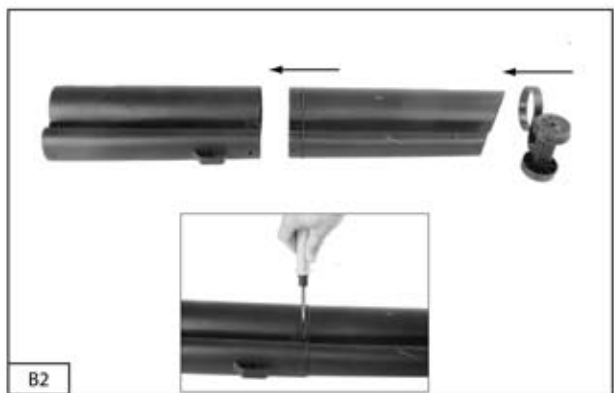

Safety Information

 This machine complies with the safety regulations for electrical equipment.

Read the operating manual carefully before using the machine for the first time. Improper use may cause damage and personal injury. Do not use the machine unless you are familiar with the operating manual. Keep the operating manual in a safe place.

Children and young people are not allowed to use the machine.



SWITCH OFF: Disconnect the plug from the mains supply before cleaning or servicing the machine.



SAFETY: Wear protective footwear when in use.



SAFETY: Wear ear defenders and goggles when in use.



Keep people out of the way when in use.



Keep people a safe distance away from the unit when in use.



DO NOT USE in wet weather or leave outdoors.



DO NOT place hand into the blade or mechanical areas.



WARNING!
Before using this appliance, make sure the vacuum tubes are in position and secured with screws!

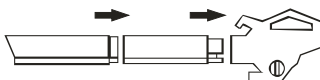

Proper usage

The machine is designed for home use. The manufacturer cannot accept any liability in the event of the machine not being used correctly or if modifications are made to the machine. Please also refer to the safety instructions, the assembly and operating manual and also to the general accident prevention regulations.

Safety instructions

Before using the blower vac for the first time you should read the following safety instructions and observe them to avoid the risk of fire, electric shock or injury. Read the operating manual carefully and follow all the operating instructions, usage restrictions and potential risks linked to using the blower vac.

Children must not be allowed to use the machine. The machine may only be used by people who are familiar with these instructions. Local regulations may impose an age restriction on use.

Do not use the machine in the vicinity of other people (particularly children) or animals. The user may be held liable for personal injury and damage, accidents and risks.

General safety instructions

Before using the blower vac for the first time you should read the following safety instructions and observe them. The safety instructions are designed to protect you and others from injury and to ensure that the blower vac will offer a long, trouble-free service life.

1. Safe operation

Follow the instructions

Read this operating manual and all the warning stickers on the blower vac and follow the instructions when you use the machine. Ensure

that you have read all the instructions, restrictions on use and potential risks relating to the blower vac and that you have understood them all.

Working area

Working areas and workbenches must be kept clean and tidy at all times. Untidy and overloaded workbenches and working areas can result in accidents and injuries. Floors and aisles must be kept clean and clear at all times and must not be blocked. Special precautions are to be taken for floors that may become slippery as a result of sawdust or floor wax.

Environment

Do not use the blower vac in damp or wet areas and protect it from rain. Your working area must always be properly lit. Do not use the blower vac in areas in which there is a risk of fire or explosions as a result of inflammable materials, liquids, paints, lacquers, petrol, gases or explosive dust, etc. We recommend that you obtain advice from a specialist about a suitable fire extinguisher and its correct usage.

Protection from electric shocks

Avoid contact with earth machine components (for example pipes, radiators, earth posts, etc.).

Protection of children and animals

Keep children and animals away from where you are working. Do not allow children to use the blower vac and ensure that children do not play with the machine or the power cable. Keep the blower vac out of the reach of children and ideally store it in a locked cupboard or room when it is not in use. Ensure that people, animals, children and physically handicapped persons keep a safe distance of at least 15 metres away from the blower vac when it is in use.

Do not use force on the blower vac

The blower vac will work better, more safely and

more reliably if it is operated at the rated load for which the machine is designed.

Select the correct machine

Always select the best machine for the job in hand. Do not use machines for work for which they are not designed. Do not use small, low power blower vacs if you have large volumes of work for them. Do not use the blower vac for work for which it is not designed.

2. For your own safety

Clothing

When working with the blower vac always wear close-fitting clothing and long trousers. Ensure that jewellery or items of clothing cannot get caught in moving machine parts.

Hair

Tie back or cover long hair.

Eye protection

When you work with the blower vac we recommend that you wear safety goggles. Conventional spectacles do not offer adequate protection for your eyes since they do not have special protective lenses.

Footwear

Wear special anti-slip safety shoes in areas where there is a risk of injury due to falling items or where there is a particular risk of slipping as a result of wet or slippery floors.

Ear protection

When working with the blower vac we recommend that you wear suitable ear protection. The loud noise generated by the blower vac can cause hearing damage if the user is exposed to it for long periods of time.

Head protection

We recommend that you wear a solid safety helmet in areas where there is a risk of injury due to falling items or where it is possible that you could strike your head on projecting objects or objects at head height.

Breathing apparatus

We recommend that you wear a dust mask when working with machines that generate fine dust.

Mains cable

Always hold the cable to the rear of you and away from the machine. Never pull the cable to disconnect the plug from the mains socket, but instead take hold of the plug and pull it. Never hang the blower vac by its mains cable or pull it behind you by its mains cable. Protect the mains cable from heat, oil, solvents and sharp objects and edges.

If the mains cable is damaged do not continue to use the machine and have the cable replaced by an authorised dealer immediately.

Balance

When working with the blower vac ensure that you have a safe, secure piece of ground to stand on so that you cannot slip or fall. Do not stand on unsafe ladders or platforms to work and do not adopt a posture from you which you can lose your balance and fall.

Care of the blower vac

Keep the blades sharp and clean at all times, otherwise the blower vac will not perform properly.

Refer to the instructions for cleaning and replacing accessory parts. Check the blower vac's mains cable at regular intervals for signs of damage and have damaged cables replaced

immediately by an authorised dealer. Check extension cables at regular intervals for signs of damage and replace damaged cables immediately. Keep the handles of the machine clean, dry and free of oil and grease at all times. Ensure that the ventilation slits are clean and not blocked by dust or leaves. Blocked ventilation slits can cause the machine to overheat and damage the motor.

Disconnect the blower vac

Always disconnect the mains plug of the blower vac when the machine is not in use and before you carry out any servicing and cleaning work or replace accessory parts (leaf bag, tubes, etc.).

Prevent the machine being switched on accidentally. Before you connect the blower vac to the mains supply, ensure that the main switch is set to the OFF position.

Cleaning the blower vac

Before you carry out any cleaning work, always disconnect the blower vac from the mains supply. Clean the blower vac with a soft, dry cloth only. NEVER use liquids or solvents.

Extension cables and cable drums

NEVER use non-earthed two-core extension cables for blower vacs that have an earth conductor.

Instead use three-core extension cables or cable drums with an earth conductor. If you use the blower vac outdoors only use extension cables that are specially designed for outdoor use and are marked accordingly. Before connecting the plug to the mains supply always unwind the extension cable fully. Damaged extension cables must not be used and must be replaced immediately.

Ensure that the extension cable or cable drum is not damaged by sharp objects and is not exposed to excessive heat, moisture or damp. Extension cables with a length of up to 15 m

should have a cable cross-section of 1.5 mm². Extension cables with a length of 15 m to 40 m should have a cable cross-section of 2.5 mm².

Concentration

When working with the blower vac concentrate on what you are doing, heed the safety instructions and never use the blower vac if you are tired, have consumed alcohol or drugs or have taken medication that may reduce your reaction times.

Check for damaged parts

Before using the blower vac check the machine to ensure that it is in perfect working order. Check that all the moving parts are correctly aligned and do not become wedged or jammed in each other. Check whether any parts are damaged or missing and have any such parts replaced or repaired by an authorised dealer. Check whether the machine has suffered any defects that may adversely affect the error-free function of the blower vac. Damaged safety covers or parts of the blower vac should be replaced or repaired immediately by an authorised dealer unless specified to the contrary in the operating manual. Switches that do not work properly must be replaced immediately by an authorised dealer. NEVER use the blower vac if the machine cannot be switched on and off using the main "ON / OFF" switch.

Warning

Do not make any changes or modifications to the blower vac. The use of additional equipment or accessory parts that are not expressly recommended in this operating manual for use with the blower vac can result in the machine suffering damage and causing personal injury to the user.

Have the blower vac repaired only by trained personnel.
This electric blower vac complies with

European standards and safety regulations.

Repairs may only be carried out by personnel trained for this type of work using only genuine spare parts. If you fail to comply with these instructions there is a considerable risk of injury for the user.

Special safety instructions

- The blower vac is for home use and is not designed for commercial or industrial applications.
- When the blower vac is not in use and before you intend to clean it or replace accessory parts, such as the leaf bag, ensure that you disconnect the machine from the mains power supply.
- Never use the blower vac if the tubes and accessory parts are not fitted correctly.
- Never use the blower vac if parts of the machine are missing or damaged. Only have the blower vac serviced or repaired by an authorised dealer.
- Do not make any changes or modifications to the blower vac, to the safety covers or to the accessory parts supplied with it.
- Always wear safety goggles, ear protection and a face mask when using the blower vac.
- Switch off the blower vac immediately and disconnect the plug from the power supply if the machine makes unusual noises or starts to vibrate wildly. Rectify the cause of the fault or have the machine serviced by an authorised dealer.
- Always carry the blower vac by the handle or the shoulder strap or push it on rollers.
- This blower vac is designed exclusively for picking up leaves.
- Never use the blower vac to pick up stones, plastic bags or the like. This sort of use may

damage the machine.

- Only use the blower vac on solid, stable ground (for example concrete, cobblestones, etc.).
- Never direct the air current from the blower vac at yourself, other people or animals.
- This blower vac is not suitable for industrial use or use in the food and sanitary sector.

IMPORTANT

This blower vac is fitted with a **BS1363** mains plug that complies with safety regulations. The blower vac must be operated with the mains voltage set out on its model plate. Connect the machine to the mains supply using an RCCB with a trip current of less than 30 mA. If the mains cable or mains plug is damaged the entire mains cable and plug must be replaced with a genuine spare part. This replacement work must be carried out by an authorised dealer. If you have any questions or problems, consult a trained electrician.

Components and controls (B1)

1. Vacuum-Blower Body.
2. On/Off Switch.
3. Vacuum/Blower selector lever.
4. Intermediate suction/blower tube.
5. Wheeled suction/blower tube.
6. Debris collection bag.
7. Supply cable

Warning!

The Vacuum-Blower must not be used or switched on until it has been fully assembled.

Assembly (B2-B3)

Pull the wheeled suction/blower tube out from the intermediate suction/blower tube, ensuring that it is fitted correctly and pull fully. Secure with the two screws provided and cover the plate.

Fitting the debris collection bag (B4)

Before fitting the debris collection bag ensure that the Vacuum/Blow selector lever operates smoothly and that it is not obstructed by debris from the previous use.

Locate the debris collection bag with the fastener inserted into the holes on both sides of discharge opening. Hang the front of the debris collection bag to the underside of the Intermediate suction-blower tube by using the clip fitted to the debris collection bag.

Fitting the shoulder harness (B5)

The Vacuum-Blower is provided with a shoulder harness, it is attached to the top of the main body of the Vacuum-Blower as shown. The shoulder harness is provided to reduce fatigue and aid comfort when using the Vacuum-Blower and can be worn in a position to suit the operator.

Remove the debris collection bag

Clamp the 2 fasteners on the side of the connection tube of debris collection bag and pull the connection tube out of discharge opening.

Before Starting.

Before starting the Vacuum-Blower plug into the mains supply via the (R.C.D.) and switch on. Check that the (R.C.D.) is operating correctly.

Starting the Vacuum-Blower. (B6-B7)

To start the Vacuum-Blower Ensure that the

wheeled suction/blower tube is fitted correctly. **Warning!** Before selecting either the Vacuum or Blow function ensure that the selector lever operates smoothly and that it is not obstructed by debris from the previous use. Select either the Vacuum or Blow function using the selector lever on the side of the machine and press the On/Off switch. If more power is required slide the speed controller from position (1) to position Max..

Stopping the Vacuum-Blower.

To stop the Vacuum-Blower unclamp the On / Off switch.

5. Working with the blower vac

Ensure that the blower vac is only connected to conventional sockets with a 220~240V alternating current supply. Only use extension cables if they are really necessary. The use of extension cables may cause a drop in voltage, which will result in the machine not performing to its peak or the motor overheating.

Using the Vacuum-Blower.

Do not attempt to pick up wet debris, allow fallen leaves etc, to dry out before using the Vacuum Blower. The Vacuum-Blower can be used to blow debris from patios, paths, driveways, lawns, bushes and borders. It will also pick up leaves, paper, small twigs and wood chippings. When the using the Vacuum Blower in Vacuum mode the debris is sucked up the suction tube before being ejected into the debris collection bag, as the debris passes through the suction fan it is partially shredded. The shredded organic debris is ideal to use as mulch around plants. **Warning!** Any hard objects, such as stones, tin cans glass etc, will damage the suction fan.

The easiest way to use the blower vac is to place the shoulder strap in a comfortable position over your shoulder and hold the rear handle at hip height so that the majority of the machine's weight rests on the rollers

When using the blower vac to pick up leaves it is best to move the machine on the rollers. This ensures that the blower vac is at the perfect height above the ground. The blower vac is designed only to pick up leaves. To avoid machine damage that is not covered by the warranty, do not use it to pick up branches, stones or other hard materials.

When using the machine as a leaf blower always work away from solid objects such as walls, fences, etc. Whilst you work do not place the blower vac tube too close to the leaves. The machine will be more effective if you keep it at a certain distance away from the leaves and blow the leaves forwards.

Switching operating mode

To switch the machine from blower mode to vacuum mode, simply switch it off at the main switch and move the function selector lever to the other position.

Blower mode

Inspect the area to be worked before starting. Remove any objects or debris that could be thrown, jammed or become entangled in the Vacuum-Blower.

Select the blow function using the selector lever on the side of the machine and switch on. With the Vacuum- Blower resting on its wheels move the Vacuum-Blower forwards directing the nozzle at the debris to be cleared. Alternatively hold nozzle just above the ground and swing the machine from side to side, moving forwards and directing the nozzle at the debris to be cleared. Blow the debris into a convenient heap then use the vacuum function to collect the debris.

Vacuum mode

Inspect the area to be worked before starting. Remove any objects or debris that could be thrown, jammed or become entangled in the

Vacuum-Blower. Select the vacuum function using the selector lever on the side of the machine and switch on. With the Vacuum-Blower resting on its wheels move the Vacuum-Blower forwards directing the nozzle at the debris to be collected. Alternatively with the Vacuum-Blower held just above the ground swing the machine from side to side, moving forwards and directing the nozzle at the debris to be collected. Do not force the nozzle into the debris as this will block the suction tube and reduce the efficiency of the machine.

Organic materials such as leaves contain a large amount of water that can cause them to stick to the inside of the suction tube. To reduce sticking the material should be left for a few days to dry out.

Leaf bag

Note: Before you remove and empty the leaf bag ensure that the machine has been disconnected from the mains power supply.

To empty the leaf bag simply open the zip fastener, empty the bag and then close the zip fastener again.

When the leaf bag is open you can also check the function of the blower vac's slide control. If there is a blockage in the machine, check this function and remove the blockage.

6. Servicing and maintenance

Daily:

Before using the machine

1) Check the blower vac for any signs of damage.

After using the machine:

- 1) Empty the leaf bag.
- 2) Check the vacuum tube and remove leaf residue.

3) Check the blower vac's slide control for leaf residue.

4) Clean the machine with a soft dry cloth.

5) Store the machine in a safe place where it is out of the reach of children.

If the machine cannot be switched on or continues to suffer malfunctions, have the blower vac checked and serviced by an authorised dealer.

7. Technical data

Rated voltage (V):	230-240 V~50 Hz
Rated power (W):	2600
No-load speed (min ⁻¹):	14000
Wind speed (km/h):	270
Capacity of collection bag (l):	35 LpA
Sound pressure level dB(A):	85.1 LwA
Sound power level dB(A):	95.8
Guaranteed sound power level dB(A):	102
Vibration (m/s ²):	7.49
Net weight (kg):	3.0

8. Repairs

If the machine fails despite our quality controls and your care, have repairs carried out only by a trained electrician.

9. Protecting the environment



Electrical and battery operated units that NO LONGER work should not be disposed of with normal household waste. They are to be collected separately, in accordance with the 2002/96 EC directive for disposal of electrical and electronic waste, and sent for proper and environmentally-friendly recycling.

Please check with your local authority for further information.





EC Declaration of Conformity

in accordance with EN ISO 17050-1:2004

We, Bonnington Plastics Limited of
Kingfisher House, Glaisdale Parkway, Bilborough, Nottingham NG8 4GP, UK

in accordance with the following Directives:

2014/30/EU	The Electromagnetic Compatibility Directive
2006/42/EC	The Machinery Directive
2006/95/EC	The Low Voltage Directive
2000/14/EC	The Noise Emission in the Environment by Equipment for Use Outdoors Directive (Annex VI)
2011/65/EU	Restriction of Hazardous Substances Directive

hereby declare that:

Product: Kingfisher Electric Garden Blower Vac
Model No.: GPOWER2/QT6266
Rated power: 2.6kW

is in conformity with the applicable requirements of the following standards and references:

EN 55014-1/A2:2011, EN 55014-2/A2:2008
EN 61000-3-2:2014, EN 61000-3-3:2013 EN 60335-1:2012/A11:2014, EN 60335-2-100:2014
EN 62233:2008, EN 50636-2:100:2014
EN ISO 3744: 1995
ISO 11094: 1991

The declared noise values are as follows:

Measured sound power level	95.8 dB LwA	Guaranteed sound power level	102 dB LwA
----------------------------	-------------	------------------------------	------------

Notified Body: TÜV SÜD Industrie Service GmbH, 80686 MÜNCHEN, Westendstraße 199, Germany No. 0036.

I hereby declare that the equipment named above has been designed to comply with the relevant parts of the above mentioned standards and is in accordance with the requirements of the Directives.

Signed by:

Damian Wielgat
Quality Manager
(Holder of Technical Documentation)
Bonnington Plastics Limited
15 July 2016

